

**Aviation Fabricators
805 North Fourth Street
Clinton MO 64735**

Document No: AF-613
Revision: (IR)
Date: May 21, 2015

***MAINTENANCE MANUAL SUPPLEMENT/
INSTRUCTIONS FOR CONTINUED AIRWORTHINESS***

For

Toilet Cabinet Seat Assembly

Document No.: AF-613

Revision "IR"

Revision Date: 05/21/15

Applicable to:

**Bombardier CL-600-2B16 Aircraft
s/n's 5619, 5634, 5647, & 5656**

These instructions supersede or add to those provided in the OEM Maintenance Manual, only where covered in the items contained herein. For limitations and procedures not contained in this supplement, consult the Component Maintenance Manual, or other approved airplane data.

REVISION PAGE

Updates to this document will be made by Aviation Fabricators Inc. Updates will be listed in the log of revisions and the effective pages will be listed below.

Log of Revisions				
REV. NO.	EFFECTED PAGE(S)	DESCRIPTION	DATE	APPROVED BY
IR	All	Initial Release	05/21/15	GRL

TABLE OF CONTENTS

MAINTENANCE MANUAL SUPPLEMENT/	1
INSTRUCTIONS FOR CONTINUED AIRWORTHINESS	1
REVISION PAGE	2
TABLE OF CONTENTS	3
1.0 INTRODUCTION	4
2.0 INSPECTION REQUIREMENTS AND OVERHAUL SCHEDULE	7
3.0 DIMENSION AND ACCESS	7
4.0 LIFTING AND SHORING	7
5.0 LEVELING AND WEIGHING	8
6.0 TOWING AND TAXIING	8
7.0 PARKING AND MOORING	8
8.0 PLACARDS AND MARKINGS	8
9.0 SERVICE INFORMATION	9

1.0 INTRODUCTION

The purpose of this Maintenance Manual Supplement and Instructions for Continued Airworthiness (ICA) is to provide the maintenance technician with the information necessary to ensure the continued airworthiness of the Aviation Fabricators toilet cabinet seat assembly, per part number 32-0378K, when manufactured in accordance with Aviation Fabricators design data included on drawing D-10610.

Modifications to an aircraft obligates the operator to include the maintenance information provided by this document into the operators aircraft Maintenance Manual and operator's aircraft scheduled maintenance program. This document defines supplementary maintenance operations and frequencies recommended by Aviation Fabricators Inc., to ensure the aircraft's airworthiness.

The information contained herein supplements the basic Airplane Maintenance Manual only in those areas listed as pertains to the toilet cabinet seat assembly. For limitations and procedures not contained in this supplement, consult the basic Airplane Maintenance Manual.

DATA

All information to support the continued airworthiness of this modification is contained in drawing D-10610 for part number 32-0378 Toilet Cabinet Seat Assembly.

Toilet Cabinet Seat Assembly
P/N 32-0378K

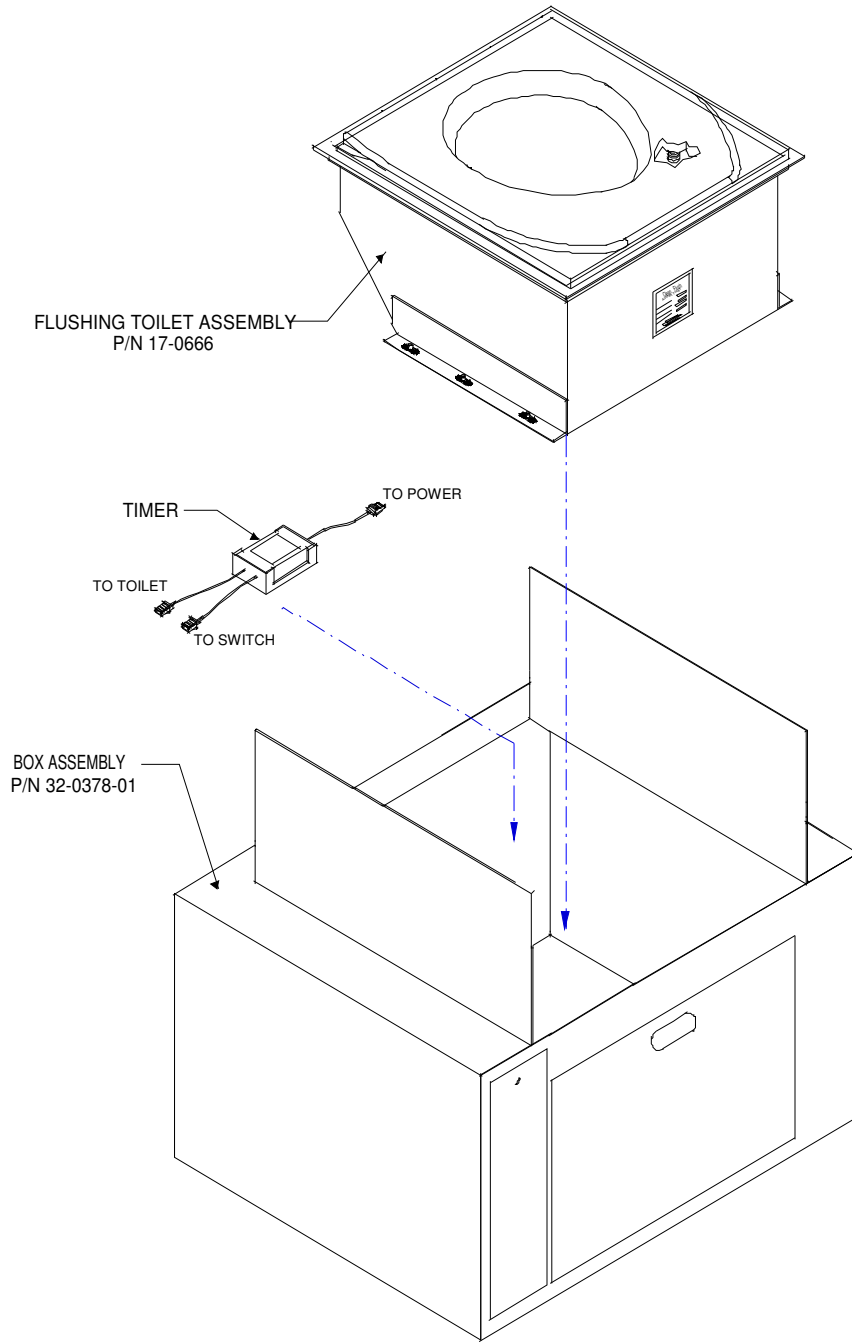

TOILET CABINET ASSEMBLY
P/N 32-0378

Figure 1.0A

Flushing Tank Assembly
P/N 17-0666

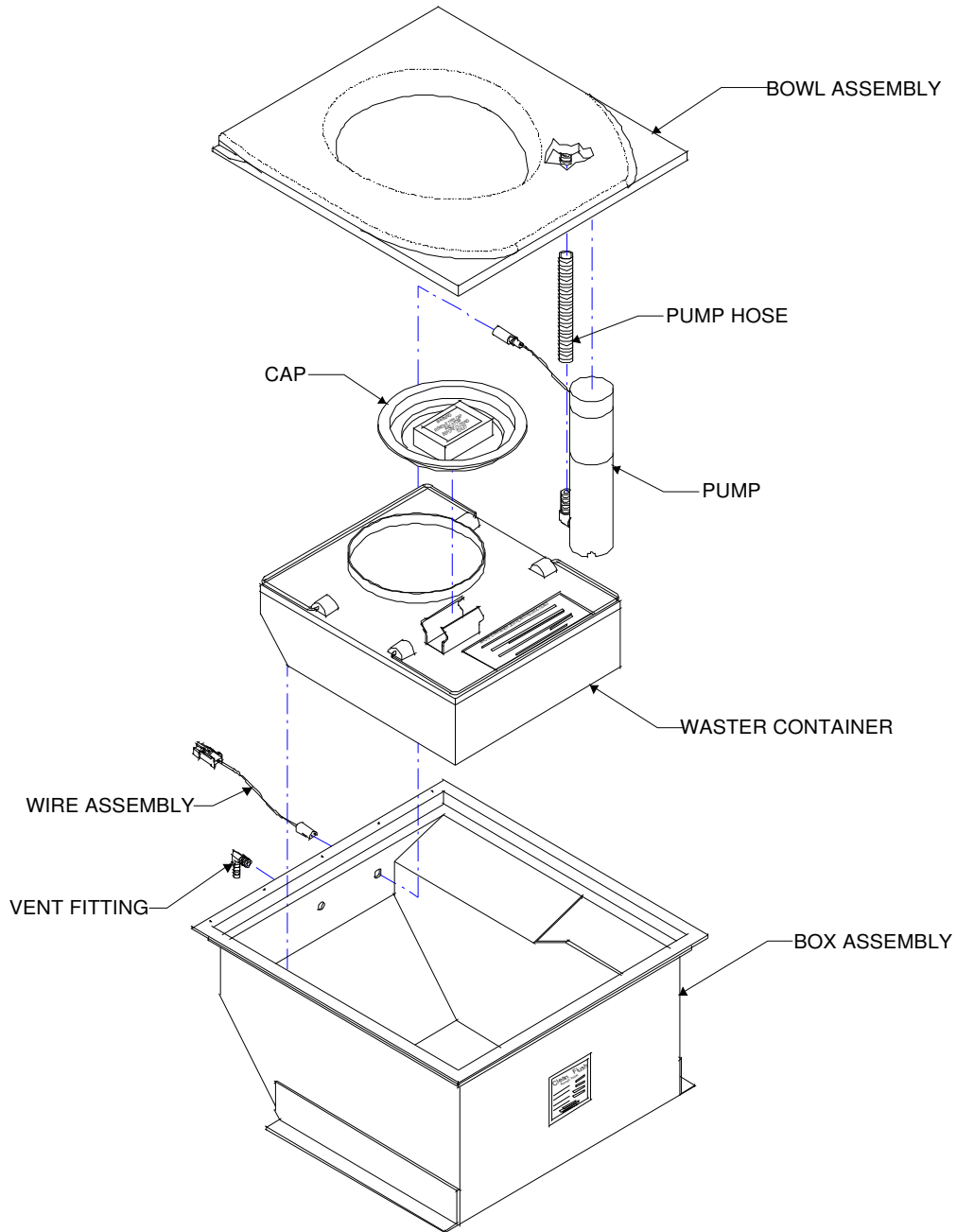

FLUSHING TOILET ASSEMBLY
P/N 17-0666

Figure 1.0B

2.0 INSPECTION REQUIREMENTS AND OVERHAUL SCHEDULE

1. The toilet cabinet assembly requires no service other than inspection at the normal inspection schedule per the OEM Maintenance Manual.

Task Code			Schedule	Date	Mech	Insp
AFI-101	a.	Inspect attaching fittings for damage, security, and function.				
AFI-102	b.	Inspect frame assembly for damage, and corrosion.				
AFI-103	c.	Inspect overall assembly for fit and function.				
AFI-104	d.	Check operation of toilet assembly.				

- A. Continue the new toilet cabinet seat assembly on the same inspection and maintenance schedule used per the OEM Maintenance Manual for passenger seats.
- B. Flushing toilet maintenance schedule:
 1. Service and clean after each flight when toilet is used.
 2. If the toilet is to remain inactive for an extended period of time, empty the water/chemical solution and thoroughly flush the system with fresh water, then drain the entire system.

3.0 DIMENSION AND ACCESS

The installation of the toilet cabinet assembly does not change the dimensions of the aircraft or alter the access to any existing aircraft system.

4.0 LIFTING AND SHORING

No change.

5.0 LEVELING AND WEIGHING

For the Flushing Toilet, the dry weight plus fluid will be used to conduct the aircraft weighing procedures for determining the empty weight of the aircraft:

Cabinet weight without any upholstery	=	27.5 lbs
Flushing Toilet weight	=	10.0 lbs
The additional fluid for the flushing reservoir	=	4.0 lbs
Total	=	<u>41.5 lbs</u>

6.0 TOWING AND TAXIING

No change.

7.0 PARKING AND MOORING

No change.

8.0 PLACARDS AND MARKINGS

1. Decal p/n 32-0378-32 is to be installed in plain view of the seat occupant.

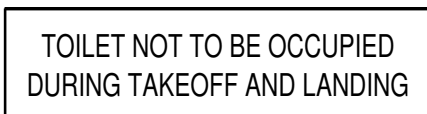

Figure 8.0A

2. Decal p/n 32-0378-34 is to be installed on the top edge of the drawer assembly.



Figure 8.0B

3. Decal p/n 32-0378-35 is to be installed on the forward edge of the shelf behind door of the toilet seat cabinet.

MAX WEIGHT 5.0 LBS OF STORAGE

Figure 8.0C

9.0 SERVICE INFORMATION

Typical Toilet Cabinet Seat Assembly Service Instructions:

A. Upholstery Cleaning:

1. Remove cushion assemblies.
2. If possible dry clean fabric cushions.
3. If dry cleaning is not possible clean fabric with Armour All fabric cleaner or equivalent.
4. Clean leather with Armour All leather cleaner or equivalent.

B. Cabinet Cleaning:

1. Clean laminate finish using Armour All multi-purpose cleaner or equivalent.

C. Flushing Unit Service Instructions:

1. For Service Instructions for p/n 17-0666 refer to Clean Flush Service Instructions for Model 50 Aircraft Toilets.